

S 1270 - 10''

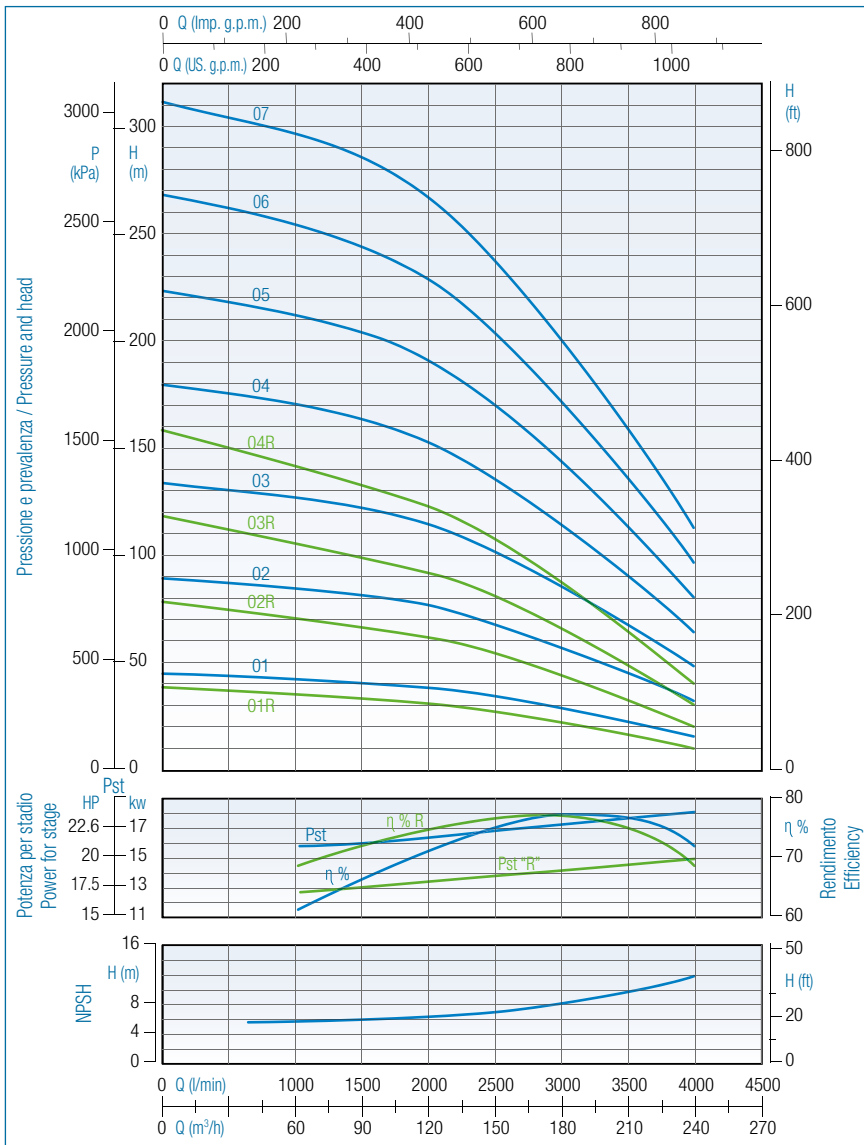

50Hz Prestazioni Performance Rendimento Performances

Tolleranza secondo norme:
Tolerance in according to:
Tolerancia según:
Tolérance selon règles:
UNI EN ISO 9906 – Grade 3B

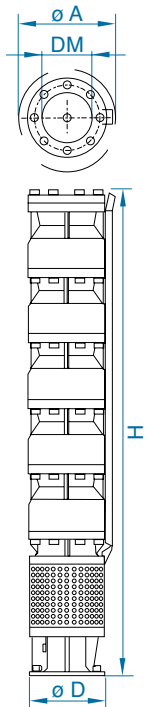

Serie	H mm	kg	DM	A1	A2	D
S1270-1R	800	80.00	G 6"	240 mm	265 mm	ø 144
S1270-01	800	80.00				
S1270-2R	975	99.00				
S1270-02	975	99.00				ø 191
S1270-3R	1150	118.00				
S1270-03	1150	118.00				
S1270-4R	1322	137.00				
S1270-04	1322	137.00	ø 232			
S1270-05	1497	156.00				
S1270-06	1672	175.00				
S1270-07	1847	194.00				

50Hz - Dati tecnici / Technical data / Datos técnicos / Données techniques

Serie	No. ST.	P ₂		Q	n=2900 R.P.M.												
		kW	HP		I/s	0	26.6	31.6	36.6	41.6	46.6	50.0	53.3	56.6	60.0	63.3	66.6
					m³/h	0	96	114	132	150	168	180	192	204	216	228	240
				I/min.	0	1600	1900	2200	2500	2800	3000	3200	3400	3600	3800	4000	
S1270-1R	1	15.00	20.00	H (m)	39	33	31	29	27	24	22	19	17	15	13	10	
S1270-01	1	18.50	25.00		45	40	39	37	34	31	29	26	24	22	20	16	
S1270-2R	2	30.00	40.00		79	66	63	59	54	48	43	38	34	29	25	20	
S1270-02	2	37.00	50.00		89	81	80	73	67	62	57	53	48	43	37	32	
S1270-3R	3	45.00	60.00		118	98	92	88	80	72	65	58	52	44	36	30	
S1270-03	3	55.00	75.00		134	121	116	110	102	93	85	80	73	64	56	48	
S1270-4R	4	59.00	80.00		158	131	125	117	107	96	87	77	69	59	50	40	
S1270-04	4	75.00	100.00		179	161	155	146	135	123	113	105	95	85	75	64	
S1270-05	5	93.00	125.00		223	201	194	183	170	153	142	131	120	107	93	80	
S1270-06	6	110.00	150.00		268	242	232	220	203	184	170	157	143	128	112	96	
S1270-07	7	130.00	175.00		312	282	271	256	238	215	199	183	167	149	132	112	

Serie	P ₂	Q	I/s	I/min	m³/h	H(m)	H	A1	A2
Tipo	Potenza	Portata	Litri al secondo	Litri al minuto	Metri cubi per ora	Prevalenza	Dimensioni	Ingombro con diffusore	Ingombro con coprifilo
Type	Power	Flow rate	Liters per second	Liters per minute	Cubic meters per hour	Head	Dimensions	Dim. with diffuser	Dim. incl. cable cover
Type	Potencia	Caudal	Litros por segundo	Litros por minuto	Metros cúbicos por hora	Altura man.	Dimensiones	Dim. con difusor	Dim. con cubrecable
Type	Puissance	Débit	Litres par seconde	Litres par minute	Mètres cubes par heure	Hauteur man.	Dimensions	Encombrement avec diffuseur	Encombrement avec couvre-câble

Modifiche tecniche senza obbligo di preavviso / Technical modifications without prior notice / Variaciones técnicas sin obligación de aviso previo / Changements techniques sans obligation de préavis

S 1278 - 10''

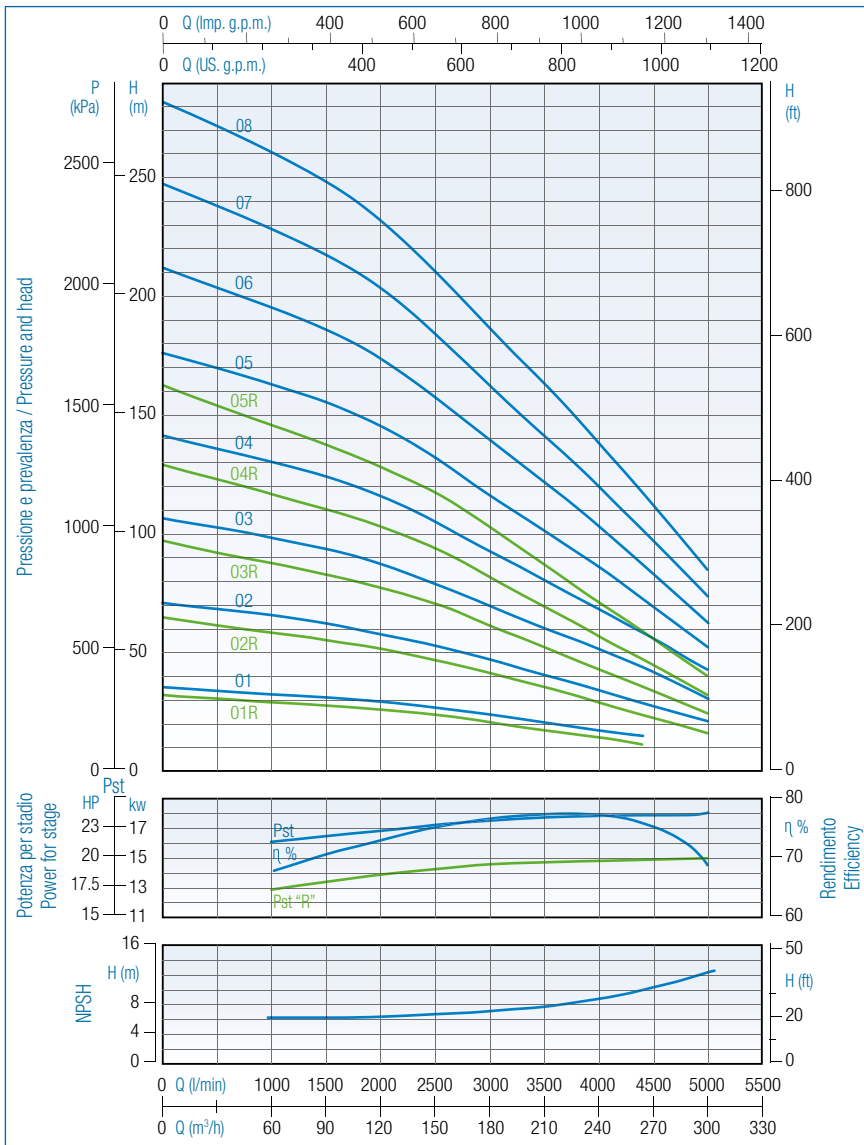

50Hz Prestazioni Performance Rendimento Performances

Tolleranza secondo norme:
Tolerance in according to:
Tolerancia según:
Tolérance selon règles:
UNI EN ISO 9906 – Grade 3B

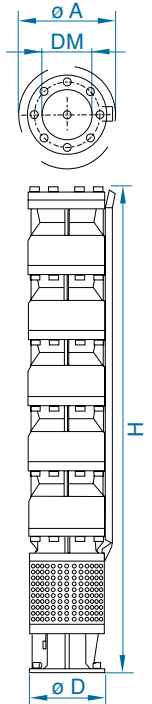

Serie	H mm	kg	DM	A1	A2	D
S1278-1R	800	80.00	G 6"	240 mm	265 mm	ø 144
S1278-01	800	80.00				
S1278-2R	975	99.00				
S1278-02	975	99.00				
S1278-3R	1150	118.00		ø 191		
S1278-03	1150	118.00				
S1278-4R	1322	137.00				
S1278-04	1322	137.00				
S1278-5R	1497	156.00	ø 232			
S1278-05	1497	156.00				
S1278-06	1672	175.00				
S1278-07	1847	194.00				
S1278-08	2235	213.00				

50Hz - Dati tecnici / Technical data / Datos técnicos / Données techniques

Serie	No. ST.	P ₂		Q	n=2900 R.P.M.												
		kW	HP		I/s	0	33.3	38.3	43.3	48.3	53.3	58.3	63.3	68.3	73.3	78.3	83.3
					m ³ /h	0	120	138	156	174	192	210	228	246	264	282	300
				I/min.	0	2000	2300	2600	2900	3200	3500	3800	4100	4400	4700	5000	
S1278-1R	1	15.00	20.00	H (m)	32	26	25	23	21	19	17	15	13	11	-	-	
S1278-01	1	18.50	25.00		35	29	28	25	24	22	20	18	16	14	-	-	
S1278-2R	2	30.00	40.00		65	51	49	46	42	38	35	21	27	23	20	16	
S1278-02	2	37.00	50.00		71	58	55	51	48	44	40	37	33	29	25	21	
S1278-3R	3	45.00	60.00		97	77	73	59	63	57	52	46	41	35	29	24	
S1278-03	3	55.00	75.00		106	87	82	77	71	65	60	55	49	43	37	31	
S1278-4R	4	59.00	80.00		129	102	97	91	84	76	69	75	54	47	39	32	
S1278-04	4	75.00	100.00		141	116	109	102	95	87	80	77	66	57	50	42	
S1278-5R	5	75.00	100.00		162	128	122	114	105	96	87	78	68	58	49	41	
S1278-05	5	93.00	125.00		176	145	137	129	119	110	101	93	82	72	51	52	
S1278-06	6	110.00	150.00		212	174	165	154	143	132	121	111	99	87	62	63	
S1278-07	7	130.00	175.00		247	203	192	179	167	139	141	130	115	101	87	73	
S1278-08	8	150.00	200.00		272	232	216	205	190	153	161	147	132	116	99	84	

Serie	P ₂	Q	I/s	I/min	m ³ /h	H(m)	H	A1	A2
Tipo	Potenza	Portata	Litri al secondo	Litri al minuto	Metri cubi per ora	Prevalenza	Dimensioni	Ingombro con diffusore	Ingombro con coprifilo
Type	Power	Flow rate	Liters per second	Liters per minute	Cubic meters per hour	Head	Dimensions	Dim. with diffuser	Dim. incl. cable cover
Tipo	Potencia	Caudal	Litros por segundo	Litros por minuto	Metros cúbicos por hora	Altura man.	Dimensiones	Dim. con difusor	Dim. con cubrecable
Type	Puissance	Débit	Litres par seconde	Litres par minute	Mètres cubes par heure	Hauteur man.	Dimensions	Encombrement avec diffuseur	Encombrement avec couvre-câble

Modifiche tecniche senza obbligo di preavviso / Technical modifications without prior notice / Variaciones técnicas sin obligación de aviso previo / Changements techniques sans obligation de préavis

S 1280 - 10''

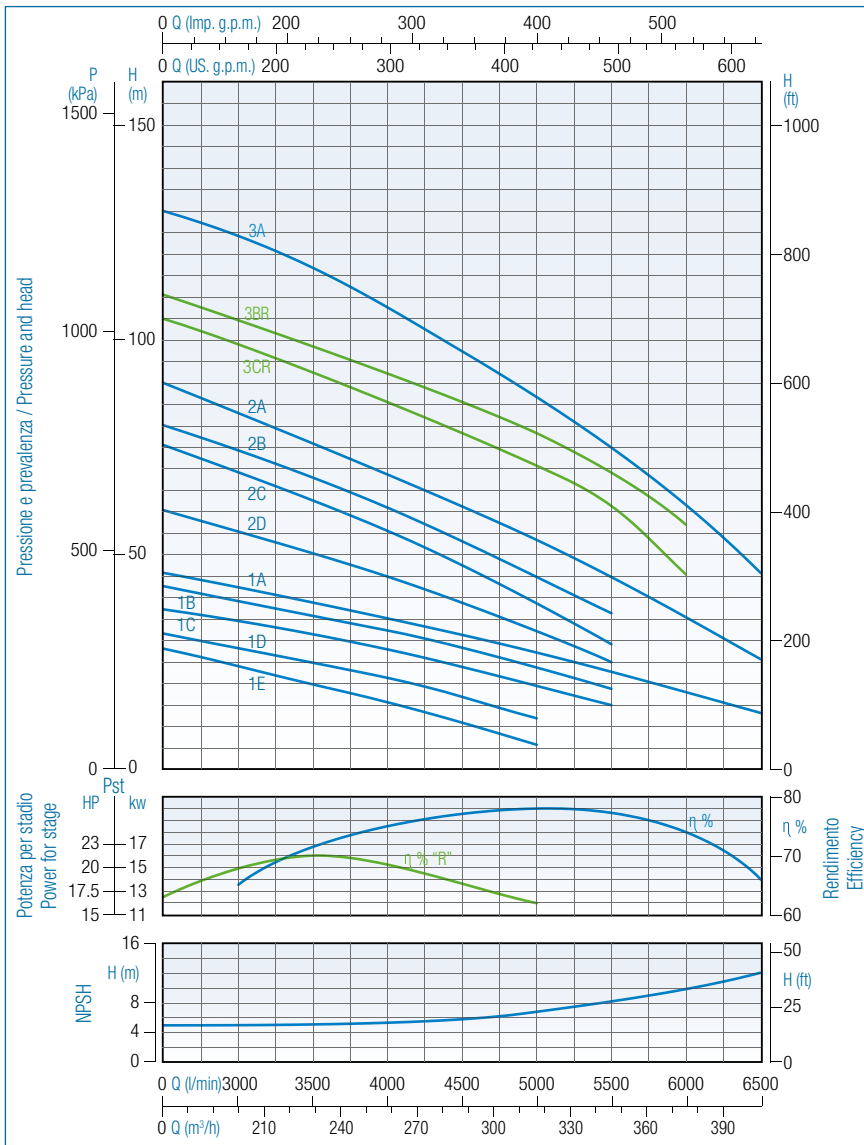

50Hz Prestazioni Performance Rendimento Performances

Tolleranza secondo norme:
Tolerance in according to:
Tolerancia según:
Tolérance selon règles:
UNI EN ISO 9906 – Grade 3B

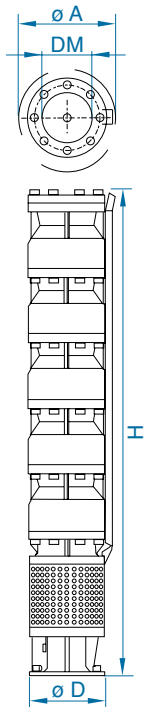

Serie	H mm	kg	DM	A1	A2	D
S1280-1E	800	80.00				ø 144
S1280-1D	800	80.00				
S1280-1C	800	80.00				
S1280-1B	800	80.00				
S1280-1A	800	80.00				ø 191
S1280-2D	975	99.00	168 mm	240 mm	265 mm	
S1280-2C	975	99.00				
S1280-2B	975	99.00				
S1280-2A	975	99.00				
S1280-3CR	1150	118.00				
S1280-3BR	1150	118.00				
S1280-3A	1150	118.00				

50Hz - Dati tecnici / Technical data / Datos técnicos / Données techniques

Serie	No. ST.	P ₂		Q												
		kW	HP	n=2900 R.P.M.												
				l/s	0	33.3	41.6	50.0	58.3	66.6	75.0	83.3	91.6	100.0	108.3	
				m³/h	0	120	150	180	210	240	270	300	330	360	390	
				l/min.	0	2000	2500	3000	3500	4000	4500	5000	5500	6000	6500	
S1280-1E	1	15.00	20.00	H (m)	28	24	22	18	17	15	10	8	-	-	-	
S1280-1D	1	18.50	25.00		32	26	24	22	21	18	16	13	-	-	-	
S1280-1C	1	22.00	30.00		37	33	31	28	26	24	22	19	16	-	-	
S1280-1B	1	26.00	35.00		41	35	32	30	29	27	25	23	20	-	-	
S1280-1A	1	30.00	40.00		45	37	35	34	32	30	28	26	24	20	16	
S1280-2D	2	37.00	50.00		64	52	48	44	42	36	32	28	23	-	-	
S1280-2C	2	45.00	60.00		74	66	62	55	51	48	45	38	33	-	-	
S1280-2B	2	51.00	70.00		82	71	65	61	59	55	51	46	41	-	-	
S1280-2A	2	59.00	80.00		87	74	70	68	64	60	56	52	48	40	31	
S1280-3CR	3	66.00	90.00		104	89	87	83	77	73	65	57	46	36	-	
S1280-3BR	3	75.00	100.00		111	98	95	91	86	81	74	65	57	42	-	
S1280-3A	3	93.00	125.00		128	111	105	102	96	90	84	78	72	60	45	

Serie	P ₂	Q	l/s	l/min	m³/h	H(m)	H	A1	A2
Tipo	Potenza	Portata	Litri al secondo	Litri al minuto	Metri cubi per ora	Prevalenza	Dimensioni	Ingombro con diffusore	Ingombro con coprifilo
Type	Power	Flow rate	Liters per second	Liters per minute	Cubic meters per hour	Head	Dimensions	Dim. with diffuser	Dim. incl. cable cover
Type	Potencia	Caudal	Litros por segundo	Litros por minuto	Metros cúbicos por hora	Altura man.	Dimensiones	Dim. con difusor	Dim. con cubrecable
Type	Puissance	Débit	Litres par seconde	Litres par minute	Mètres cubes par heure	Hauteur man.	Dimensions	Encombrement avec diffuseur	Encombrement avec couvre-câble

Modifiche tecniche senza obbligo di preavviso / Technical modifications without prior notice / Variaciones técnicas sin obligación de aviso previo / Changements techniques sans obligation de préavis

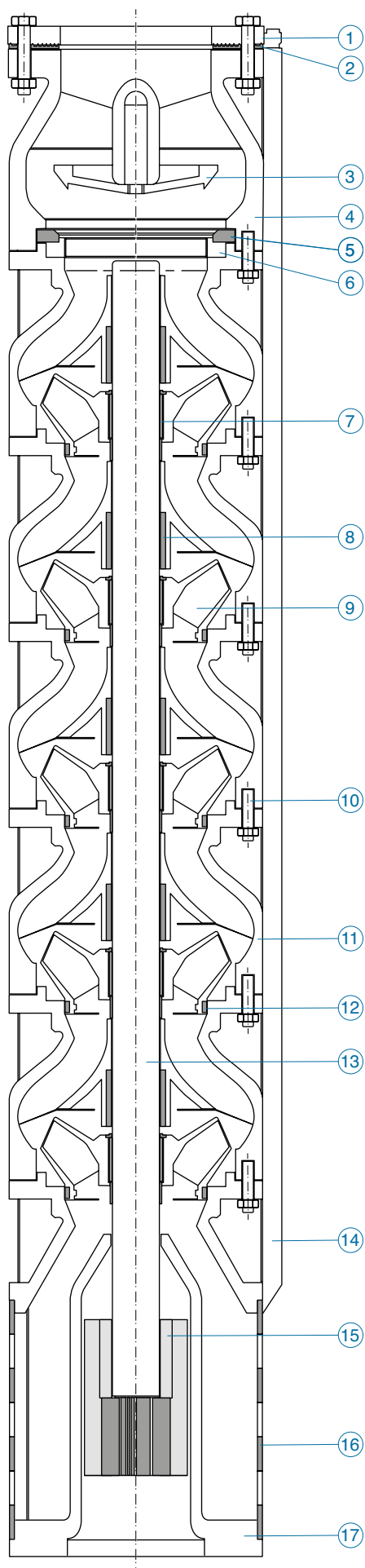

Lista parti di ricambio
Spare parts list
Lista de repuestos
Liste des pièces de rechange

IT	EN	ES	FR
1 Flangia	Flange	Brida	Bride
2 Guarnizione flangia	Flange seal	Sello de brida	Garniture de bride
3 Valvola	Valve	Válvula	Valve
4 Corpo di mandata	Flow body	Cuerpo de caudal	Corps de débit
5 Anello valvola	Valve ring	Anillo de la válvula	Anneau de la valve
6 Supporto anello valvola	Bracket valve ring	Soporte del anillo de la válvula	Support de anneau de la valve
7 Boccola conica	Conic bushing	Buje cónico	Bague conique
8 Cuscinetto	Bearing	Cojinete	Palier
9 Girante	Impeller	Impulsor	Roue
10 Bulloni	Bolts	Pernos	Boulons
11 Diffusore	Diffuser	Difusor	Diffuseur
12 Anello sede girante	Impeller ring	Anillo impulsor	Anneau roue
13 Albero	Shaft	Eje	Arbre
14 Ripara cavo	Cable protection	Protección del cable	Protection du câble
15 Giunto	Joint	Acoplamiento	Joint
16 Filtro di aspirazione	Aspiration filter	Filtro de aspiración	Filtre d'aspiration
17 Supporto di aspirazione	Aspiration bracket	Soporte de aspiración	Support d'aspiration